



# FRONT ELEVATION

SCALE:  $\frac{1}{4}'' = 1'-0''$

©design basics inc.

note: all MAIN FLOOR WALLS ARE 9'-1 1/8" HIGH UNLESS NOTED OTHERWISE

note: all exterior walls are 4" (3/2" stud + 1/2" SHEATHING) all interior walls are 3/2" unless otherwise shown

note: all angled walls are @ 45°

(A) 1 1/8" i-joists @ 16" o.c.

(B) 2x8 raft's @ 24" o.c.

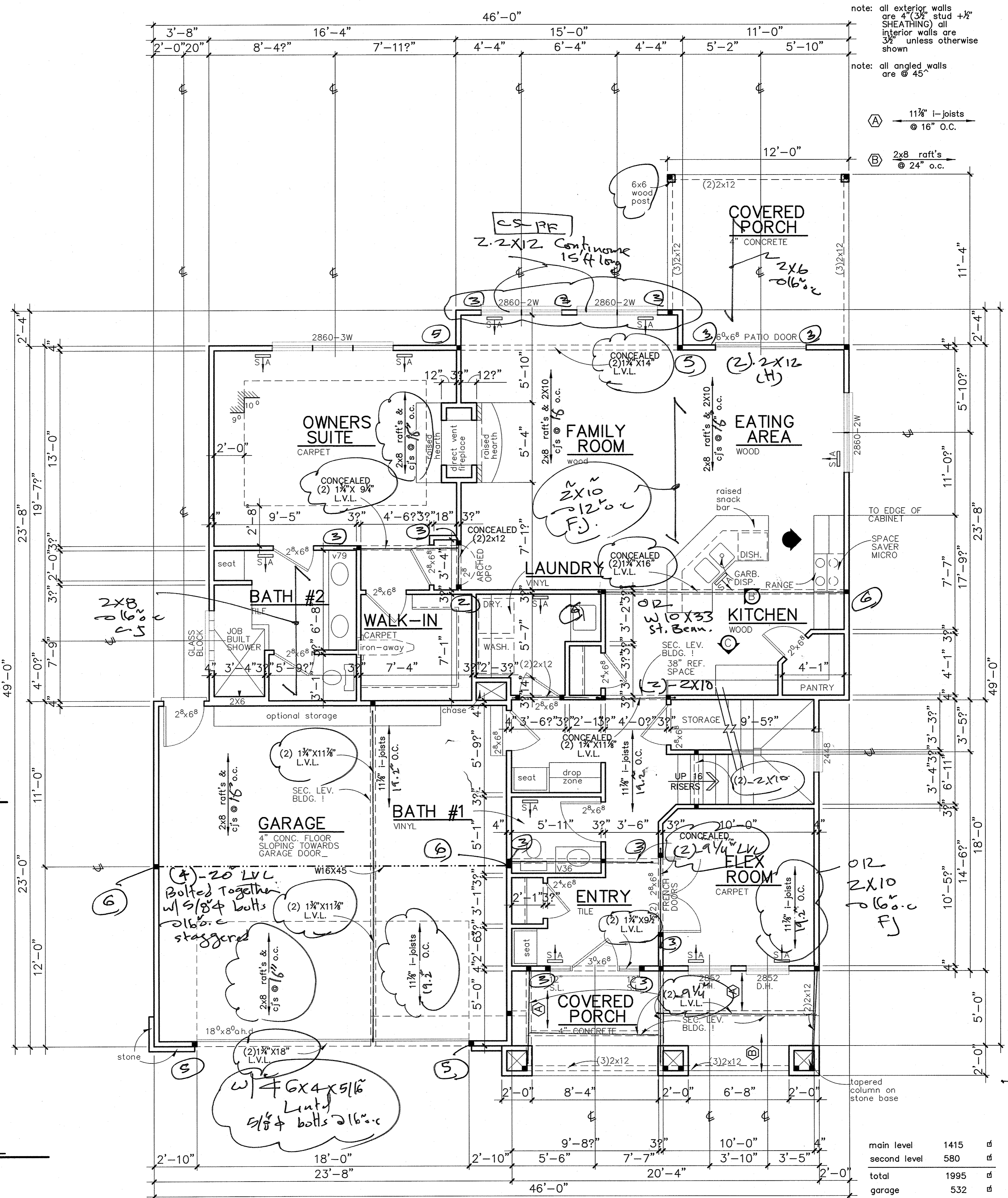

TO EDGE OF CABINET  
SPACE SAVER MICRO

(6)

(C)

(B)

(3)

(3)

(3)

(3)

(3)

(3)

(3)

(3)

(3)

main level	1415	sq
second level	580	sq
total	1995	sq
garage	532	sq

main floor plan

SCALE: 1/4" = 1'-0"

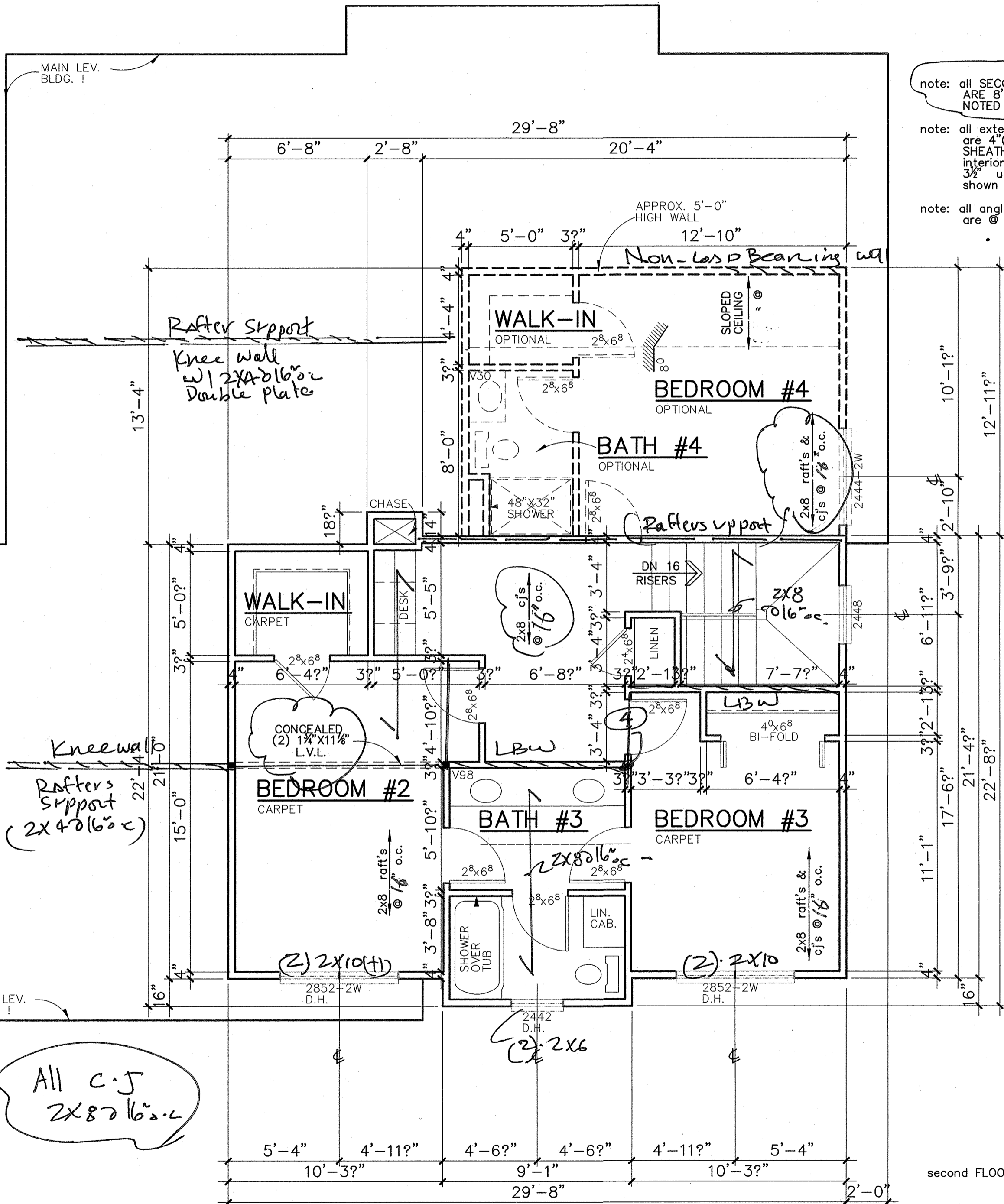

note: all SECOND FLOOR WALLS ARE 8'-1 1/8" HIGH UNLESS NOTED OTHERWISE

note: all exterior walls are 4" (3/2" stud + 1/2" SHEATHING.) all interior walls are 3/2" unless otherwise shown

note: all angled walls are @ 45°

Kneewall  
Rafter support  
(2x4 @ 16" o.c.)

All C-J  
2x8 @ 16" o.c.



TAKLA ENGINEERING, PLLC  
FIRM LICENSE NO. P-1446  
SEAL FOR STRUCTURAL ONLY  
919-358-1758

### second floor plan

SCALE: 1/4" = 1'-0"